

# HOW TO HANG OUR WALLPAPER

## USEFUL INFORMATION

These hanging instructions are provided to aid you in correctly hanging your new wallpaper, please read carefully before cutting or hanging this product. To ensure that you have the correct number of rolls, check the match type of your wallpaper and length repeat to ensure that you have enough paper inclusive of wastage to complete your project. If any of your rolls are damaged do not proceed to hang.

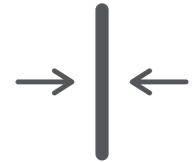

### Straight Match Wallpaper

A straight-match wallpaper has a design that matches edge-to-edge with each drop because the design from left to right across each drop is the same. The match type is indicated by the symbol on your roll.

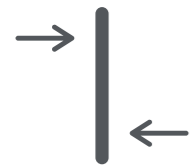

### Offset Match Wallpaper

An offset match wallpaper has a design that, in order to be matched up every other drop must be offset by a specific distance. This is indicated on each roll as the length repeat. The match type is indicated by the symbol on your roll.

## BEFORE HANGING

To make sure that each roll of wallpaper will match up, check that all rolls have the same batch number and are the same colour and design.

Wall surfaces should be clean, dry and smooth before hanging your wallpaper. If papering on to a freshly plastered wall, we recommend painting with a suitable primer before hanging to ensure that the paste adheres sufficiently to the paper.

Any holes, cracks or lumps and bumps should be filled with a good quality filler, smoothed out to create a level surface and sanded once dry.

Brush off the area to be covered with wallpaper using a stiff brush to remove all dust, debris and all loose material.

## TOOLS YOU WILL NEED TO HANG THE WALLPAPER

**Paste-the-wall ready-mixed wallpaper paste**

**Paste brush or roller** to apply the paste

**A soft dry cloth** to clear any debris or dust from the wall

**A lightly dampened cloth or sponge** to wipe off excess paste

**Sharp knife** to cut the paper

**Spirit level or plumb line**

**Pencil** to mark your starting point

**Tape measure or ruler**

**Stepladder**

**Soft bristled brush** to smooth out wallpaper

**Artist chalk or pastel** to prevent white edges showing at the seams, dark coloured wallpapers may need their edges colouring with a slightly lighter chalk or pastel

## HANGING INSTRUCTIONS

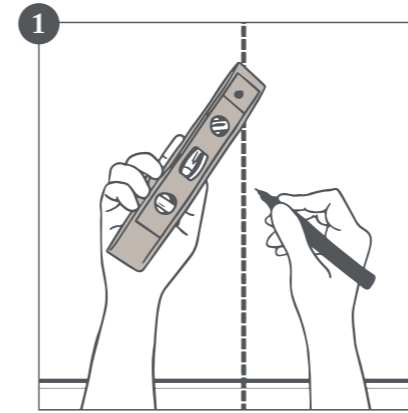

### Step 1: Measure and plan where to start

You can choose to hang the first drop from either a corner of the room, or where there is strong natural light. The first drop to be hung must be applied to the wall straight. A spirit level is highly recommended to assist you in achieving this, as every subsequent drop will be affected by the placement of the first. If hanging from an inner corner, measure the first drop width a couple of centimetres short; this will ensure that the paper's edge overlaps and completely fills the inner corner down the full height of the wall, reducing the likelihood of an unsightly gap as walls are very rarely perfectly straight. With a pencil, mark the wall at the paper's edge and using a spirit level, draw a vertical line all the way down the wall. This will ensure that your first drop is hung as straight as possible.

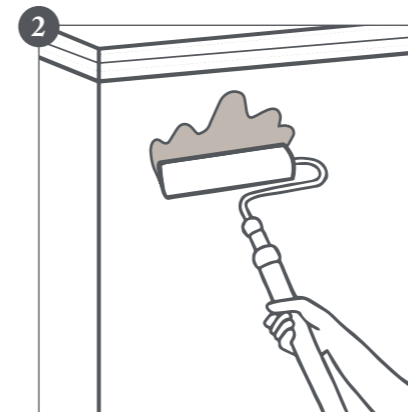

### Step 2: Apply the wallpaper paste to the wall

Apply the paste-the-wall wallpaper paste to the wall with a paste brush or roller, pasting beyond the plumb line (drawn with the aid of a spirit level). This will allow you to reposition the drop if you need to make any adjustments or straighten up the drop.

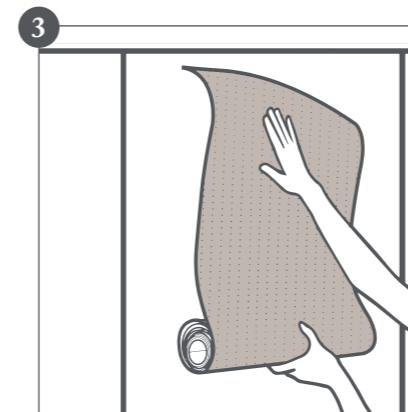

### Step 3: Apply the wallpaper to the wall

With the adhesive applied to the wall, the wallpaper can be hung straight from the roll. Use a ladder to hang the first drop from the top of the wall (below any coving) to the bottom of the wall, allowing a little extra of the product at the top to ensure that the full height of the wall is covered across the length of the drop. For now, leave the still attached roll on the floor. Smooth down the paper with a soft-bristled brush working outwards from the centre, down the length of the drop to the skirting board. Once you are happy with the position of the first drop, you can cut the excess from the top and bottom of the roll with a sharp knife. If you need to reposition the drop, do so gently and whilst the adhesive is still wet.

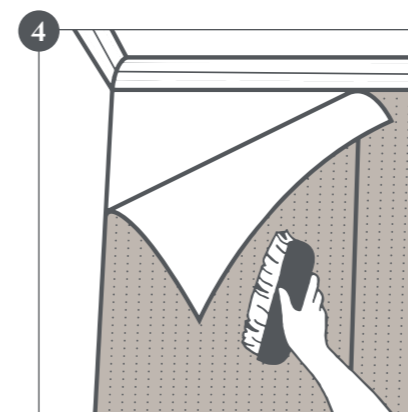

### Step 4: Paste and repeat

Continue to paste the wall section by section and hang each drop from top to bottom according to the pattern match repeat. Each drop should be hung with a butted seam so that each edge is touching the next but not overlapping. Ensure that any excess paste is gently wiped from the surface of the paper before it dries.

If you have any other queries, please contact your retailer.